

LOW PROFILE CYLINDERS

10-100 TON CAPACITY | 1.5"-2.5" STROKE | 10,000 PSI MAX. PRESSURE

FEATURES

- Designed for use in confined spaces
- Plunger wiper seal keeps out contamination and debris
- Upper and lower bronze bearings for minimal wear of cylinder rod and maximizing lifetime of cylinder
- Industrial grade spring for increased spring performance and lifetime
- Industrial grade steel construction withstands even the most demanding of applications
- Chrome plated piston rod eliminates corrosion and rust
- 3/8" NPTF female coupler and dust cap on all models

High Flow Coupler included on all models



					A	B	C	D	E	F	G	H	I		
Capacity	Stroke	Model #	Cylinder Effective Area	Oil Cap.	Collapsed Height	Extended Height	Outside Diameter	Cylinder Bore Dia.	Plunger Diameter	Base to Coupler Port	Saddle Distance above Cylinder	Piston Thread Length	Saddle Diameter	Weight	
(tons)	(in.)		(in. ²)	(in. ³)	(in.)	(in.)	(in.)	(in.)	(in.)	(in.)	(in.)	(in.)	(in.)	(lbs.)	
10	1.51	SL101	2.47	3.7	3.5	5.01	2.76	1.77	1.57	0.61	0.04	0.28	1.42	5.73	
20	1.76	SL202	4.38	7.7	3.88	5.64	3.62	2.36	1.97	0.61	0.04	0.31	1.5	10.36	
30	2.46	SL302	6.85	16.8	4.63	7.09	4.02	2.95	2.56	0.63	0.04	0.35	2.13	14.77	
50	2.49	SL502	9.86	24.6	5.01	7.5	4.88	3.54	2.76	0.73	0.04	0.55	2.36	22.27	
100	2.25	SL1002	20.57	46.3	5.59	7.84	6.5	5.12	3.54	1.16	0.04	0.55	2.91	43.21	

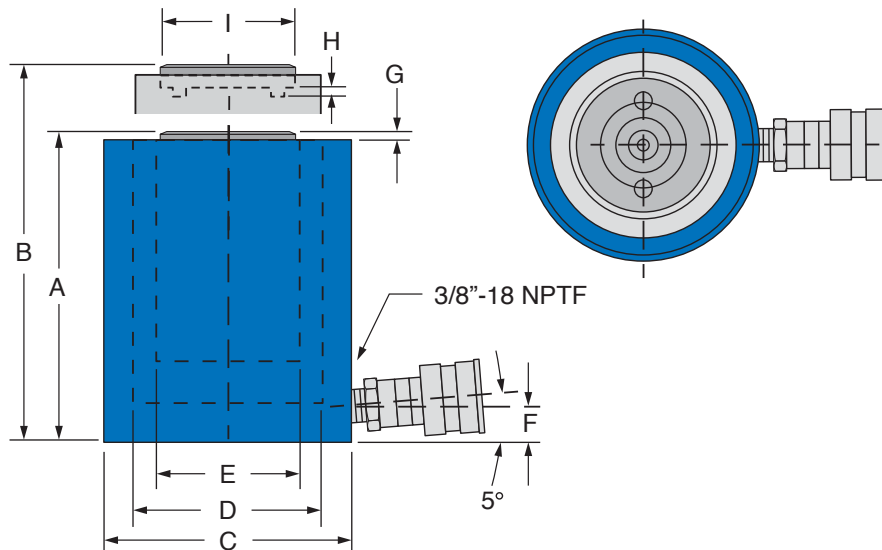

California residents - These products may contain a chemical known to cause cancer or reproductive harm. www.P65Warnings.ca.gov